

ABERDEEN CITY COUNCIL
The Granite City Woodlands
Woodland Creation Programme
Phase I Proposals



December 2009

Prepared on behalf of Aberdeen City Council
by
Chris Piper MICFor
C J Piper & Co, Chartered Foresters
Killearnan, Alexandra Terrace, Forres, Moray IV36 1DL
Tel: 01309 674374 Mob: 07802 833263
chrispiper@supanet.com



Contents

	<i>Page No</i>
1 Introduction & Background	3
2 Vision	4
3 Context	7
4 Strategic Aims, Objectives & Outcomes	8
5 Proposals & Timescales	11
6 Financial Forecasts and Funding	14
7 Next Steps	

I Introduction & Background

Aberdeen City Council (ACC) is looking to undertake a programme of new woodland creation as a tangible contribution to achieving its vision for Aberdeen to be “a city which is vibrant, dynamic and forward looking” and through its commitment to planting a tree for every citizen by 2011.

This new planting, which is proposed to be carried out in two phases over the next 2 to 3 years commencing in 2010, combined with enhanced management of its other existing woodlands, is also part of the Councils’ commitment to demonstrating the increasingly significant role that urban woodlands and green space network play in enhancing the City’s environmental fabric and general quality of life as well as helping to reduce carbon emissions and mitigating climate change.

Assisted by Forestry Commission Scotland’s Woodlands in and Around Towns (WIAT) Challenge funding, the City Council is currently in the process of completing management plans for the majority of the Council-owned woodlands across the City. A key output of the management plan process has been to help identify and prioritise key areas of land that are available and strategically well suited for this woodland creation programme and that would complement and enhance the contribution that the Council’s existing woodlands already make to delivering a wide range of environmental, economic and community-related objectives and beneficial outcomes.

This document is a summary proposal for **Phase One** of the woodland creation programme which will help bring to fruition the future expansion of ACC’s woodlands under the banner of “The Granite City Woodlands”. This will be achieved in a spirit of partnership (including possibilities for co-funding), consultation and involvement with other organizations and agencies - notably Aberdeen Greenspace with whom ACC is already a strategic partner - and the communities of Aberdeen City themselves.



5 Proposals & Timescales

5.1 Phase I Summary

Phase One of the Granite City Woodlands new woodland creation programme will be carried out over a three year period **commencing in 2010** and will focus on ten individual schemes located within Aberdeen City as shown on the map extract below.

These ten schemes are referred to as follows :

Danestone, Balgownie Drive, Seaton Community Woodland, Westfield Park, Greenfern, Howes Road, Inverdee Pitches, Abbotswell, St Fittick's and Lochinch.

Strategic Locations of "The Granite City Woodlands" Phase I Planting Programme

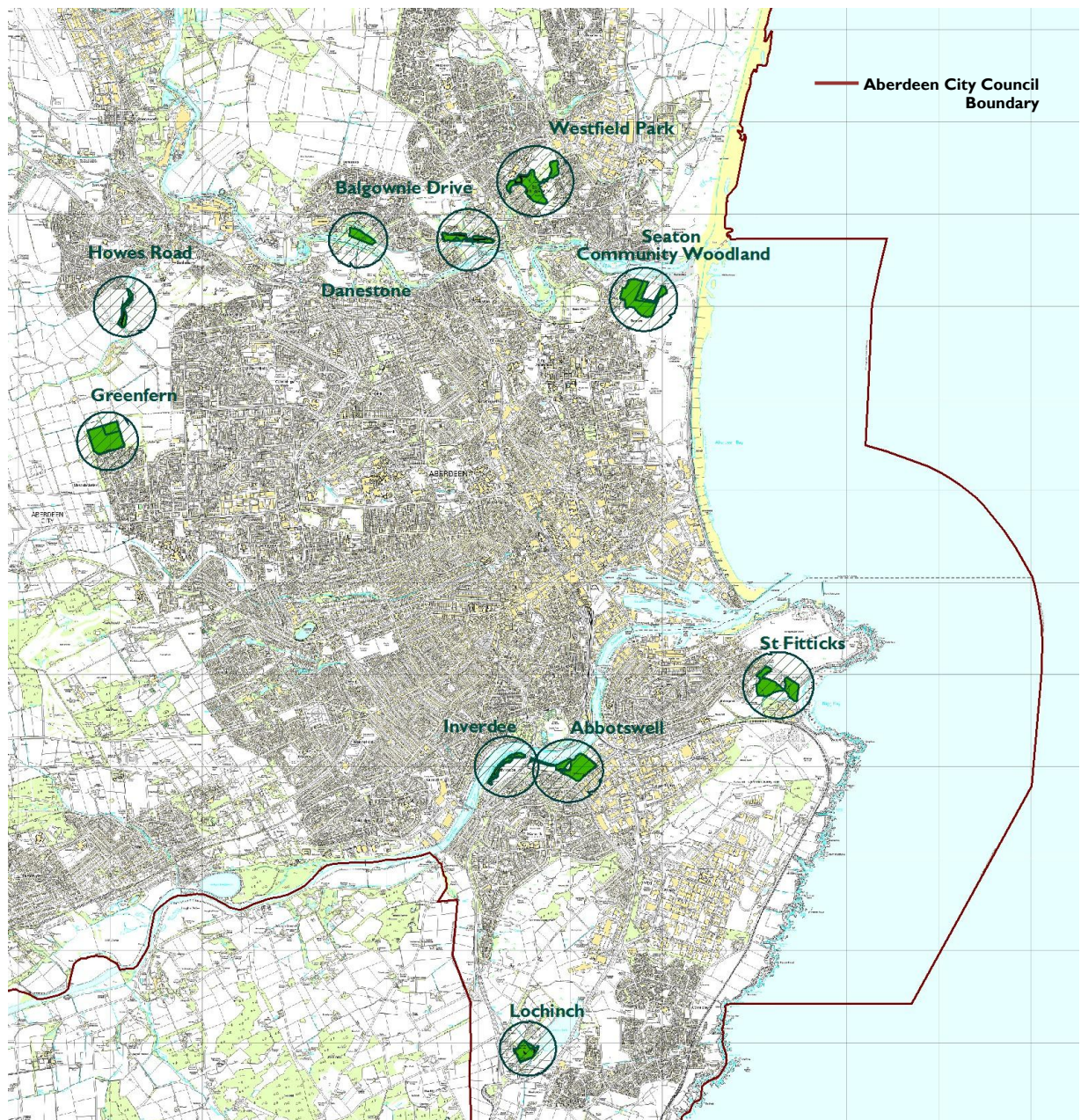

5.2 Individual scheme sites

Location plans of the individual scheme boundaries are show below.

Danestone

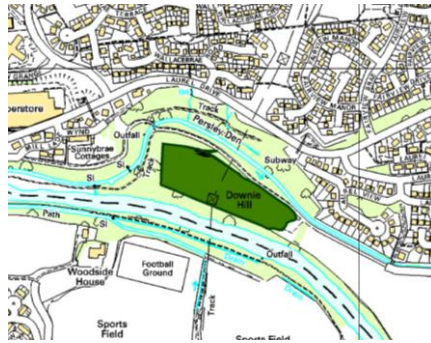

Balgownie Drive

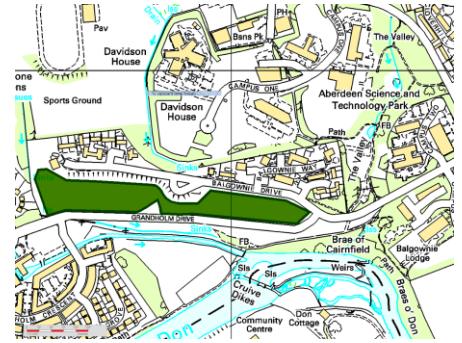

Greenfern



Seaton Community Woodland



Howes Road

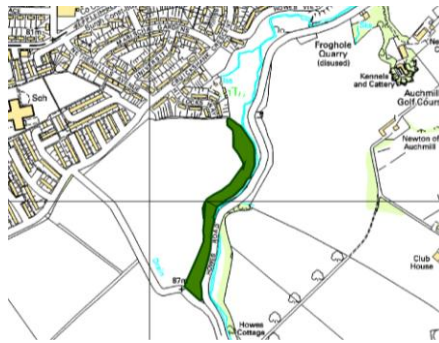

Inverdee



Lochinch

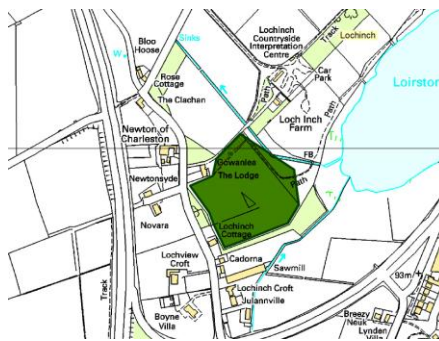

Abbotswell



St Fitticks



Westfield Park



6 Financial Forecasts and Funding

6.1 Financial Forecasts

The combined projected Phase I Planting Programme costs and funding revenues across all ten of the new woodland creation areas are set out in Table 2 below. This indicates an overall project cost of some **£343,500** over the initial three year project period. This will be funded jointly through the Scotland Rural Development Programme (SRDP - Rural Priorities), Aberdeen City Council and Aberdeen Greenspace.

**Table 2: Phase I Woodland Creation Programme: Years 1-3
Summary Forecast of Establishment Costs & Funding Revenue**

Item	(££)				££/ ha
	2010/11	2011/12	2012/13	Totals	
Establishment & Community Involvement Costs*					
Ground preparation, planting & fencing costs	197,244	-	-	197,244	3,967
Plantation maintenance and weed control	35,787	22,729	6,529	65,045	1,311
Project management	34,955	3,409	2,938	41,302	832
Community consultation, involvement & rangering	20,000	10,000	10,000	40,000	806
Totals	287,985	36,138	19,467	343,590	6,927
Funded by:					
SRDP (Rural Priorities)					
Woodland creation (all capital items)	141,818	-	-	141,818	2,859
Community Contribution	74,580	-	-	74,580	1,500
Other					
Aberdeen City Council <i>(in-kind through its Countryside Ranger Service)</i>	20,000	10,000	10,000	40,000	806
Aberdeen City Council <i>(Interrg IVB SURF Programme)</i>	10,000	10,000	5,000	25,000	504
Aberdeen Greenspace	41,587	16,138	4,467	62,192	1,644
Totals	248,811	18,000	15,000	343,590	6,927

* All costs are exclusive of VAT as Aberdeen City Council can reclaim recoverable VAT.

The above costs and funding revenues are further broken by individual planting schemes in subsequent Tables overleaf.

6.2 Funding

As indicated in Table 2 above, the principal source of funding to support the Phase I programme will be through the SRDP Rural Priorities scheme. This is discretionary funding. However, the Project proposals fit closely with the relevant SRDP eligibility criteria and Forestry Commission Scotland has indicated its strong support for the planting proposals. Assuming SRDP applications are successful, this funding would contribute about 63% of the initial plantation establishment and community involvement and ranger costs.

In addition to a cash contribution of £25,000 from Aberdeen City Council's Interreg IVB SURF Programme, ACC will provide in-kind funding through its Countryside Ranger Service which will have a key role in the facilitation and encouragement of community consultation and, wherever possible and practical, involvement of local community volunteers as well as regular and on-going rangership of the scheme sites, notably over the critical first 3-5 of plantation establishment.

ACC has secured the remaining funding through a grant offer of £62,000 Aberdeen Greenspace - a number of the individual schemes being particularly well suited and located to help deliver Aberdeen Greenspace's own strategic aims and objectives. These five schemes are separately itemised in Table 4.

Table 3: Phase I Woodland Creation Programme: Years 1-3 Summary Forecast of Establishment & Community Involvement Costs by Individual Scheme

Scheme	Year 1- 3 Costs (££)			Total Establishment Costs (££)	Community Involvement & Rangering (££)	Total Scheme Costs (££)	SRDP Woodland Creation Grant (££)	SRDP Community Contribution (££)	Net Cost (Years 1-3) (££)
	Fencing & Planting	Plantation Maintenance	Project Mgt						
Seaton Community Woodland*	32,713	11,244	7,094	51,050	6,726	57,777	24,518	12,810	20,449
Lochinch	9,841	4,001	2,733	16,575	2,184	18,758	7,927	4,935	5,897
Abbotswell*	24,918	8,103	5,773	38,793	5,111	43,905	19,556	10,425	13,924
Inverdee Pitches	13,400	5,420	1,553	20,373	2,684	23,058	4,009	2,805	16,243
Westfield Park*	31,423	10,688	6,271	48,382	6,375	54,757	20,388	11,325	23,044
St Fitticks	29,888	8,460	6,006	44,353	5,844	50,197	22,709	10,845	16,643
Danestone	9,263	2,256	1,827	13,346	1,758	15,104	7,637	3,300	4,167
Balgownie Road	13,470	2,946	2,234	18,651	2,457	21,108	10,170	4,035	6,903
Greenfern	22,025	7,920	6,371	36,316	4,785	41,101	21,195	11,505	8,401
Howes Road	10,305	4,007	1,437	15,749	2,075	17,824	3,709	2,595	11,520
Totals	197,244	65,045	41,300	303,590	40,000	343,590	141,818	74,580	127,190

* *Highligthed rows denote Aberdeen Greenspace Priority Panting Schemes*



Table 4: Phase I Woodland Creation Programme: Years 1-3 Summary Forecast of Establishment Costs for Aberdeen Greenspace High Priority Sites

Scheme	Year 1- 3 Costs (££)			Total Establishment Costs (££)	Community Involvement & Rangering (££)*	Total Scheme Costs (££)	SRDP Woodland Creation Grant (££)	SRDP Community Contribution (££)	Net Cost (Years 1-3) (££)
	Fencing & Planting	Plantation Maintenance	Project Mgt						
Seaton Community Woodland	32,713	11,244	7,094	51,050	6,726	57,777	24,518	12,810	20,449
Abbotswell	24,918	8,103	5,773	38,793	5,111	43,905	19,556	10,425	13,924
Inverdee Pitches	13,400	5,420	1,553	20,373	2,684	23,058	4,009	2,805	16,243
Westfield Park	31,423	10,688	6,271	48,382	6,375	54,757	20,388	11,325	23,044
St Fitticks*	29,888	8,460	6,006	44,353	5,844	50,197	22,709	10,845	16,643
Totals	132,340	43,915	26,697	202,952	26,740	229,693	91,180	48,210	90,302

* Based on a *pro rata* of total notional costs of £40,000 allocated by scheme area

7 Next Steps

Immediate next steps

- ◆ Submit Land & Business Change Forms to SGRPID to obtain Field Identification Numbers (FIDs) for the planting scheme areas (these are required before SRDP applications can be committed to FCS for approval). **(Done)**
- ◆ Submit relevant planting proposals to FCS for placing on the Public Register. **(Done)**
- ◆ ACC submits SRDP application(s) to FCS. **(In progress)**
- ◆ ACC prepares contract specification(s) and tender documents for establishment works. **(Done)**
- ◆ Commence programme of community consultation for the planting schemes. **(Commenced)**
- ◆ Prepare programme / timetable of establishment works for contractors and community volunteers. **(In progress)**

Chris Piper, MICFor

C J Piper & Co, Chartered Foresters
 Killearnan, Alexandra Terrace, Forres, Moray IV36 1DL
 Tel: 01309 674374
 Mobile: 07802 833263
 Email: chrispiper@supanet.com

December 2009



THE GRANITE CITY WOODLANDS Phase 1 Woodland Creation Programme

Summary Planting & Fencing Requirements *(all Schemes)*

Scheme	Gross Area (ha)	Net plantable area (ha)	Open space (ha)	% Open Space	Trees			Fence (m)	Tree Shelters
					Con	B'leaf	Totals		
Seaton	8.54	8.16	0.38	5	10,478	8,573	19,050	1,503	2,400
Lochinch	3.29	2.97	0.32	10	3,933	3,218	7,150	0	650
Abbotswell	6.95	5.36	1.59	23	6,025	6,025	12,050	1,122	2,650
Inverdee	1.87	1.68	0.19	10	2,800	1,200	4,000	0	4,000
Westfield Park	7.55	6.09	1.46	19	7,290	4,860	12,900	1,185	5,550
St Fittick's	7.23	5.80	1.43	20	9,275	3,975	13,250	1,745	2,400
Danestone	2.20	1.88	0.32	15	2,350	2,350	4,700	707	0
Balgownie Road	2.69	2.24	0.45	18	3,300	2,200	5,470	1,066	250
Greenfern	7.55	6.38	1.11	14	8,250	8,250	16,500	1,266	0
Howes Road	1.73	1.45	0.28	16	1,763	588	2,350	0	2,350
Totals	49.60	42.01	7.53	15	55,463	41,238	97,420	8,594	20,250

 ABERDEEN CITY COUNCIL	THE GRANITE CITY WOODLANDS Phase 1 Woodland Creation Programme	Ref No: Cpt 6
Area: 8.54ha	Seaton Community Woodland	Grid Ref: NJ 94770913

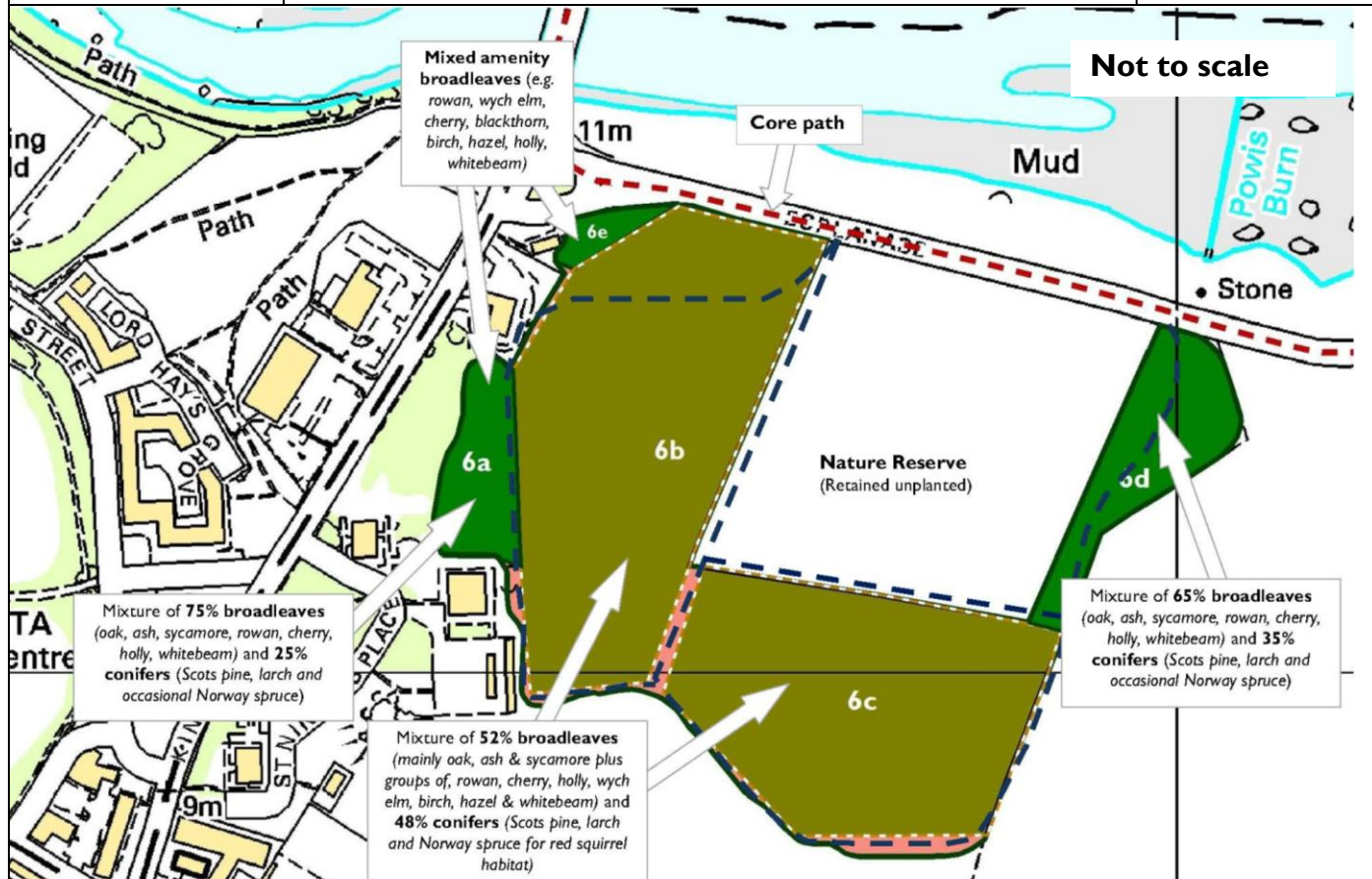

Reproduced from Ordnance Survey mapping with the permission of the Controller of Her Majesty's Stationery Office. © Crown Copyright. Unauthorised reproduction infringes Crown Copyright and may lead to prosecution or civil proceedings. Aberdeen City Council - Licence No. 100023401 (2009)*

Sub Cpt	Area (ha)	Net plantable area (ha)	No. of trees	Species Mix		Fence (m)	Tree Shelters
				% Broadleaves	% Conifers		
a	0.52	0.52	850	75	25	-	850
b	3.66	3.66	9,150	52	48	816	-
c	3.00	3.00	7,500	52	48	687	-
d	0.85	0.85	1,350	65	35	-	1,350
e	0.13	0.13	200	75	25	-	200
Other	0.38	-	-	-	-	-	-
Totals	8.54	8.16	19,050	54	46	1,503	2,400
Notes	5% open space						

Species Schedule

Sub Cpt	Broadleaves													Conifers			
	Oa	Syc	Ash	W/E	Ch	Row	Ho	B/T	Bi	Hz	W/B	Sal	Al	SP	L	NS	DF
a	100	150	100	40	40	40	25	40	40	35	40			75	75	50	
b	1,400	1,600	1,400	40	50	50	20	50	30	40	20			1,600	1,550	1,300	
c	1,200	1,200	1,200	60	50	50	10	40	30	50	10			1,300	1,300	1,000	
d	200	200	200	40	50	50	20	50	40	40	10			150	150	150	
e				25	20	25	15	20	10	25	10			20	20	10	
Totals	2,900	3,150	2,900	205	210	215	90	200	150	190	90			3,145	3,095	2,510	

	THE GRANITE CITY WOODLANDS Phase 1 Woodland Creation Programme	Ref No: Cpt 2
		FID No:

Area: 3.29ha	Lochinch	Grid Ref: NJ 9349 0089
------------------------	-----------------	----------------------------------

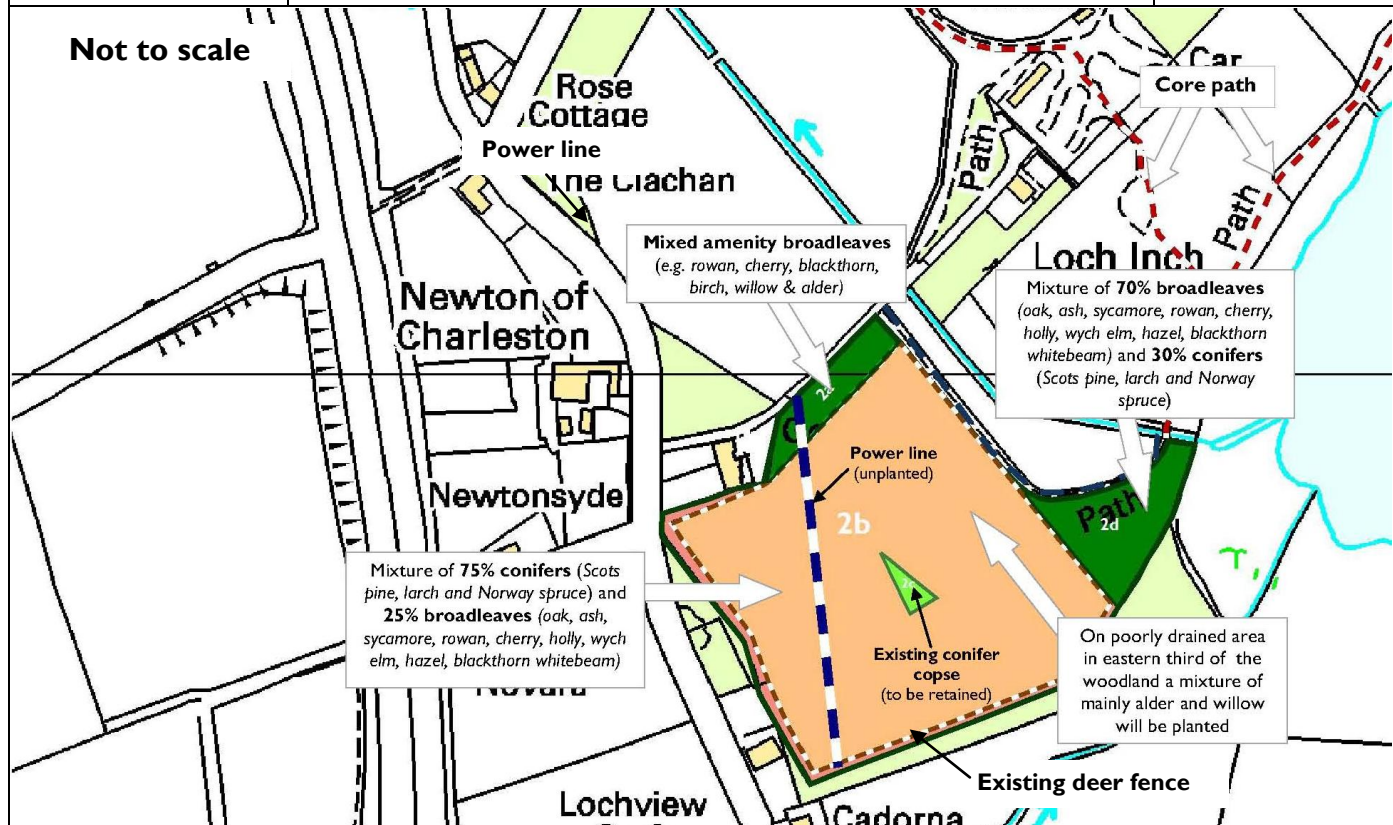

Reproduced from Ordnance Survey mapping with the permission of the Controller of Her Majesty's Stationery Office. © Crown Copyright. Unauthorised reproduction infringes Crown Copyright and may lead to prosecution or civil proceedings. Aberdeen City Council - Licence No. 100023401 (2009)*

Sub Cpt	Area (ha)	Net Plantable Area (ha)	No of trees	Species Mix		Fence (m)	Tree Shelters
				% Broadleaves	% Conifers		
a	0.07	0.07	150	93	7	-	150
b	2.61	2.61	6,500	54	46	656	
c	0.03	Copse				-	
d	0.29	0.29	500	70	30	-	500
Other	0.29						
Totals	3.29	2.97	7,150	56	44	656	650

Notes 656m existing deer fence requires addition of rabbit fence (SRDP rate =£1.90/m), plus new deer fence gate needed to allow machinery access. Note inclusion of power line, not previously identified. Approx 340% of area is wet and rush dominated and will require dolloping, draining (towards north east corner) and hand planting rather than use of the Bracke planter.

Species Schedule

Sub Cpt	Broadleaves													Conifers			
	Oa	Syc	Ash	W/E	Ch	Row	Ho	B/T	Bi	Hz	W/B	Sal	Al	SP	L	NS	DF
a	10		10		10	20		20	10			30	30	5	5		
b		1,000	600					50	400			700	750	1,500	1,000	500	
d	100		100		25	50		25	50					50	50	50	
Totals	110	1,000	710	-	35	70	-	95	460	-	-	730	780	1,555	1,055	550	-

 <p>ABERDEEN CITY COUNCIL</p>	<p>THE GRANITE CITY WOODLANDS Phase 1 Woodland Creation Programme</p>	<p>Ref No: Cpt 1</p>
		<p>FID No:</p>
<p>Area: 6.95ha</p>	<p>Abbotswell</p>	<p>Grid Ref: NJ 9406 0400</p>

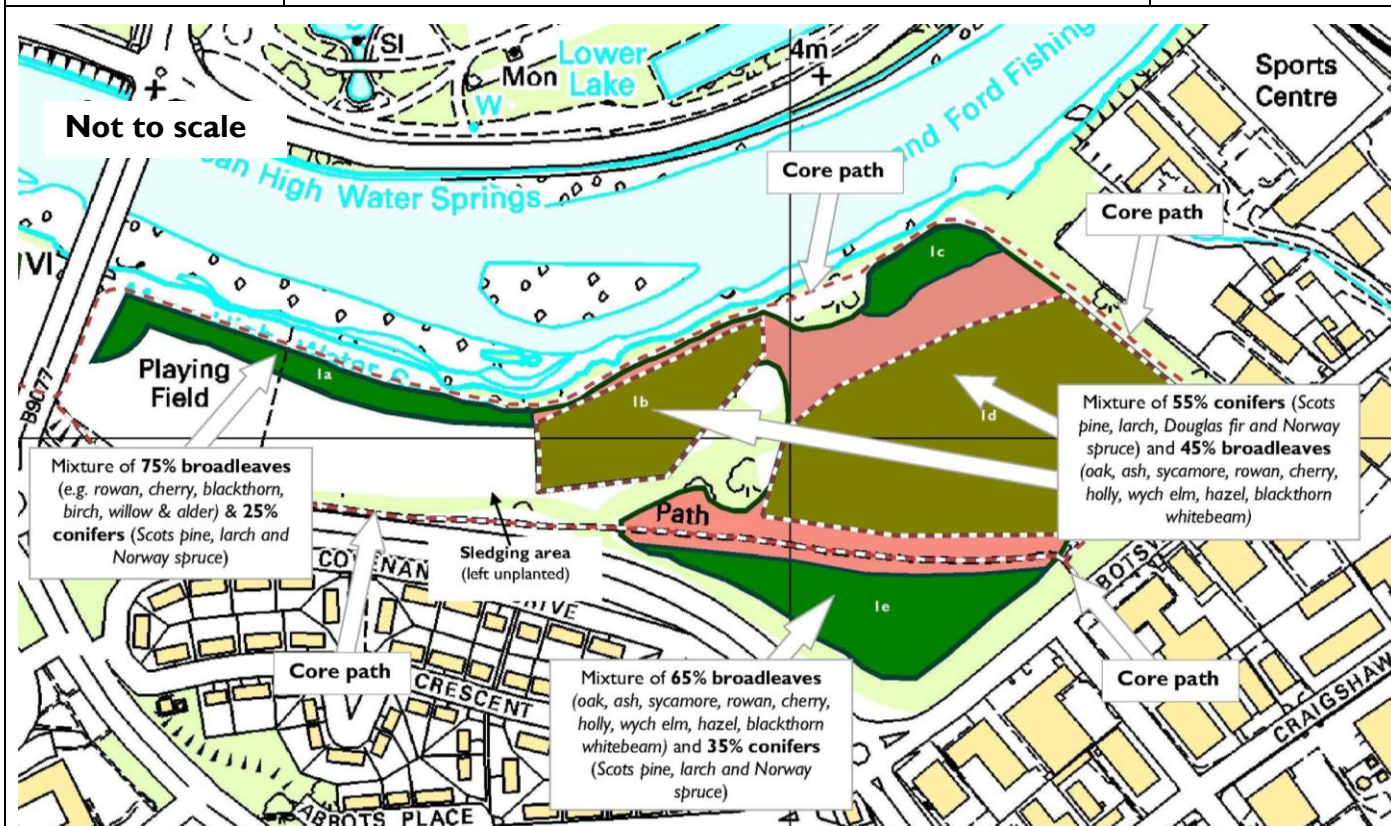

Reproduced from Ordnance Survey mapping with the permission of the Controller of Her Majesty's Stationery Office. © Crown Copyright. Unauthorised reproduction infringes Crown Copyright and may lead to prosecution or civil proceedings. Aberdeen City Council - Licence No. 100023401 (2009)"

Sub Cpt	Area (ha)	Net Plantable Area (ha)	No of trees	Species Mix		Fence (m)	Tree Shelters
				% Broadleaves	% Conifers		
a	0.47	0.47	750	75	25	-	750
b	0.80	0.80	2,000	45	55	415	
c	0.23	0.23	400	75	25	-	400
d	2.95	2.95	7,400	45	55	707	
e	0.91	0.91	1,500	65	35	-	1,500
Other	1.59	-	-				
Totals	6.95	5.36	12,050	50	50	1,127	2,650
Notes	23% open space						

Species Schedule

Sub Cpt	Broadleaves													Conifers			
	Oa	Syc	Ash	W/E	Ch	Row	Ho	B/T	Bi	HZ	W/B	Sal	Al	SP	L	NS	DF
a	200		200	50	25	25	10	10		10	10		10		70	60	
b	400		400	100	25	25	10	10		10	10		10	400	400	100	100
c	75		75	25	20	20	10	20		15	15		25	30	30	20	20
d	1,000	1,000	1,000	50	25	25	10	15	40	20	15			1,800	1,700	500	200
e	250	250	250	50	50	50	10	20	30	20	20			200	200	50	50
Totals	1,925	1,250	1,925	275	145	145	50	75	70	75	70	-	45	2,500	2,400	730	370

 <p>ABERDEEN CITY COUNCIL</p>	<p>THE GRANITE CITY WOODLANDS Phase 1 Woodland Creation Programme</p>	<p>Ref No: Cpt 3</p>
		<p>FID No:</p>
<p>Area: 1.87ha</p>	<p>Inverdee Pitches</p>	<p>Grid Ref: NJ 9324 0487</p>

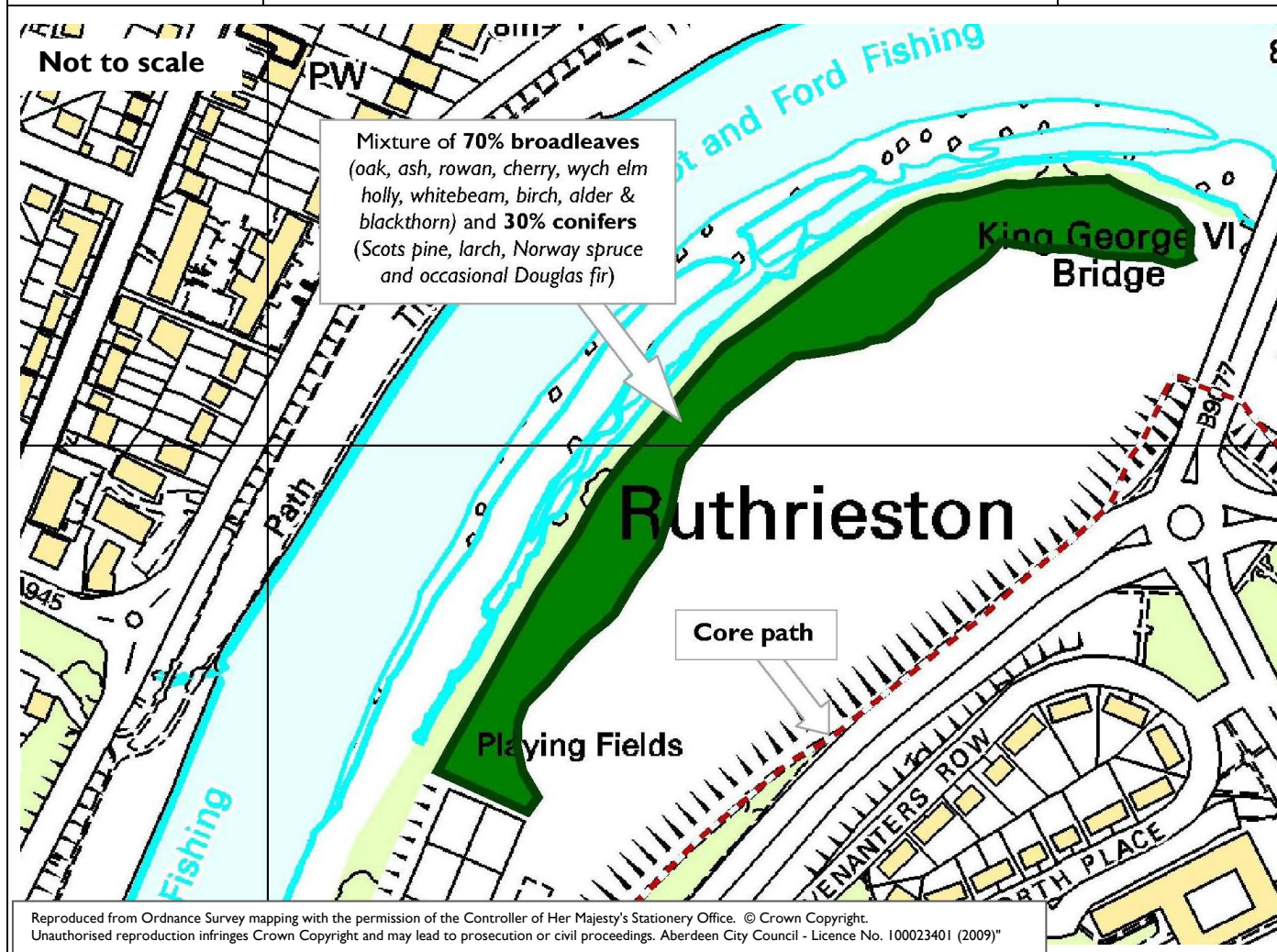

Reproduced from Ordnance Survey mapping with the permission of the Controller of Her Majesty's Stationery Office. © Crown Copyright. Unauthorised reproduction infringes Crown Copyright and may lead to prosecution or civil proceedings. Aberdeen City Council - Licence No. 100023401 (2009)"

Sub Cpt	Area (ha)	Net Plantable Area (ha)	No of trees	Species Mix		Fence (m)	Tree Shelters
				% Broadleaves	% Conifers		
a	1.87	1.68	4,000	70	30	-	4,000
Totals	1.87	1.68	4,000	70	30	-	4,000
Notes							

Species Schedule

Sub Cpt	Broadleaves													Conifers			
	Oa	Syc	Ash	W/E	Ch	Row	Ho	B/T	Bi	Hz	W/B	Sal	Al	SP	L	NS	DF
a	1,250		1,200	100	25	25	10	50	70	25	20		25	450	450	200	100
Totals	1,250	-	1,200	100	25	25	10	50	70	25	20	-	25	450	450	200	100

 <p>ABERDEEN CITY COUNCIL</p>	<p>THE GRANITE CITY WOODLANDS Phase 1 Woodland Creation Programme</p>	<p>Ref No: Cpt 5</p>
		<p>FID No:</p>
<p>Area: 7.55ha</p>	<p>Westfield Park</p>	<p>Grid Ref: NJ 9356 1030</p>

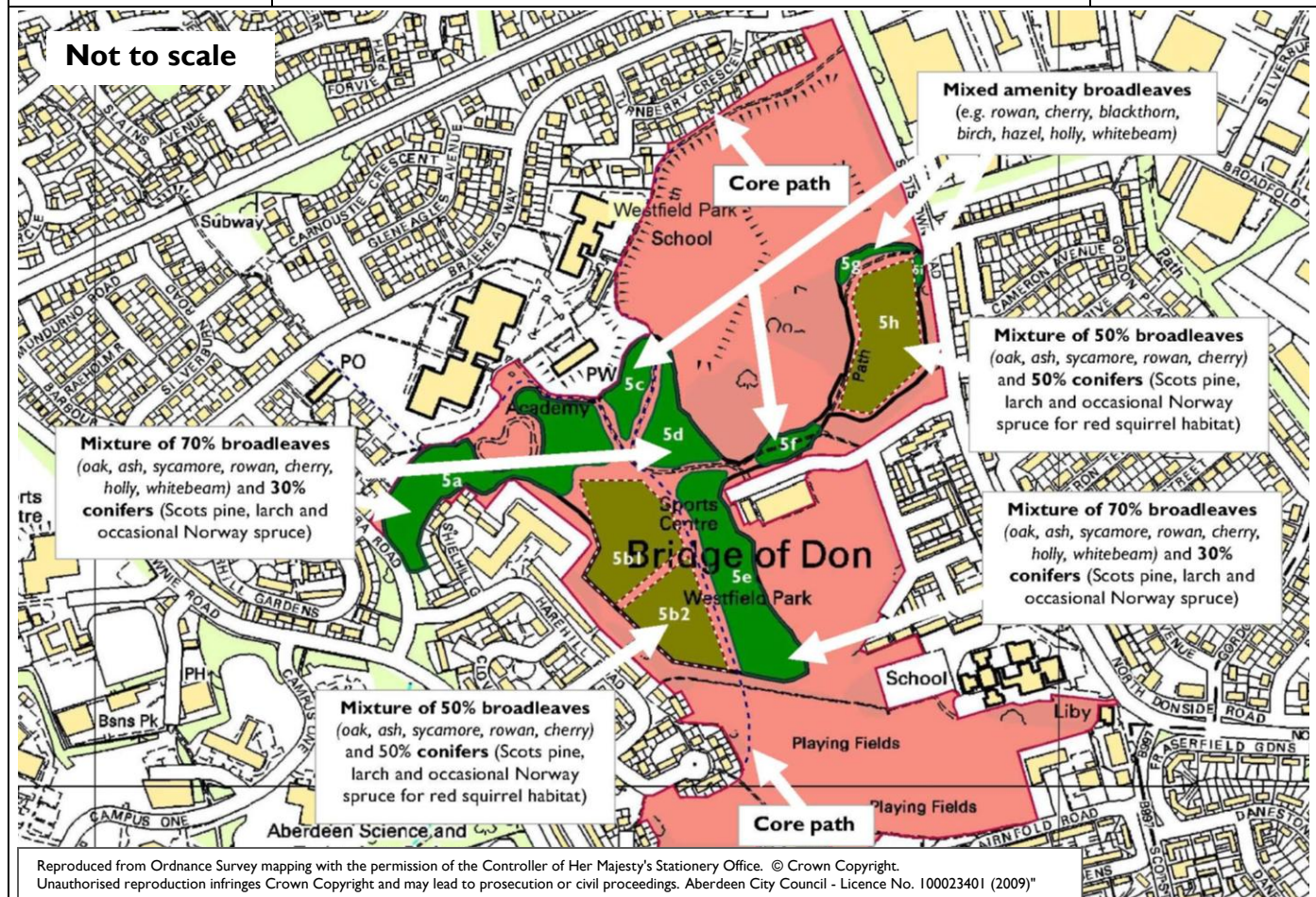

Sub Cpt	Area (ha)	Net Plantable Area (ha)	No of trees	Species Mix		Fence (m)	Tree Shelters
a	1.38	1.38	2,200	70	30	-	2,200
b	1.70	1.70	4,250	50	50	589	0
c	0.28	0.28	450	65	35	-	450
d	0.46	0.46	750	70	30	-	750
e	1.09	1.09	1,750	70	30	-	1,750
f	0.15	0.15	250	90	10	-	250
g	0.07	0.07	100	90	10	-	100
h	0.94	0.94	2,350	50	50	428	0
i	0.02	0.02	50	90	10	-	50
Open space	1.46						0
Totals	7.55	6.09	12,150	60	40	1,017	5,550

Species Schedule

Sub Cpt	Broadleaves													Conifers			
	Oa	Syc	Ash	W/E	Ch	Row	Ho	B/T	Bi	H2	W/B	Sal	Al	SP	L	NS	DF
a	500		500	50	50	50	35	30	30	25	30			350	350	200	
b	600	800	600	25	50	50	25	25	25	25	25			800	800	300	100
c	50	50	75	20	20	20	10	10	10	10	25			50	50	50	
d	100	100	100	20	20	20	15	15	20	20	20			100	100	100	
e	500	500	500	50	50	50	20	35	35	25	35			300	300	100	
f				75	35	35	15	20	20	10	15			15	10		
g	20		20	10	10	10	5	5			10			5	5		
h	400	400	400	25	25	25	15	15	15	15	15			400	400	200	
i	10		10	10	5	5					5			5			
Totals	1,925	1,250	1,925	275	145	145	50	75	70	75	70	-	45	2,500	2,400	730	370

	<h2>THE GRANITE CITY WOODLANDS</h2> <h3>Phase 1 Woodland Creation Programme</h3>	Ref No: Cpt 7
		FID No:
Area: 2.69ha	<h2>Balgownie Drive</h2>	Grid Ref: NJ 9289 0971

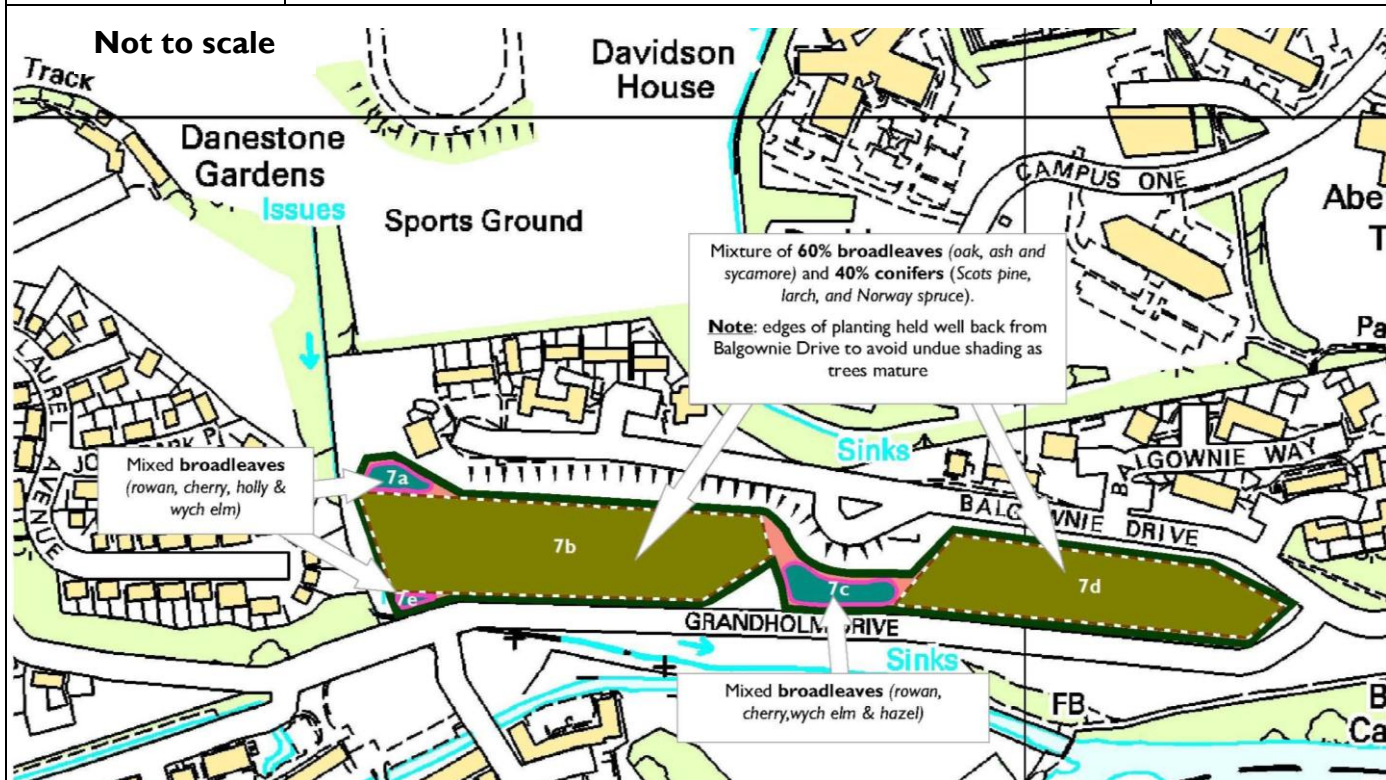

Reproduced from Ordnance Survey mapping with the permission of the Controller of Her Majesty's Stationery Office. © Crown Copyright. Unauthorised reproduction infringes Crown Copyright and may lead to prosecution or civil proceedings. Aberdeen City Council - Licence No. 100023401 (2009)"

Sub Cpt	Area (ha)	Net Plantable Area (ha)	No of trees	Species Mix		Fence (m)	Tree Shelters
				% Broadleaves	% Conifers		
a		0.05	80	100	100	-	100
b		1.23	3,100	60	40	572	-
c		0.11	175	100	100	-	200
d		0.84	2,100	60	40	526	-
e		0.01	15	60	40		15
Other	0.49	-	-				
Totals	2.69	2.24	5,470	60	40	1,066	315
Notes	18% open ground						

Species Schedule

Sub Cpt	Broadleaves												Conifers				
	Oa	Syc	Ash	W/E	Ch	Row	Ho	B/T	Bi	Hz	W/B	Sal	Al	SP	L	NS	DF
a				20	15	15	15				15						
b	700	600	600											400	400	400	
c				30	30	20				30	30			10	15	10	
d	400	300	400											400	300	300	
e					5	5					5						
Totals	1,100	900	1,000	50	45	35	15	-	-	30	45	-	-	810	715	710	-

	THE GRANITE CITY WOODLANDS Phase 1 Woodland Creation Programme	Ref No: Cpt 9
		FID No:
Area: 7.67ha	Greenfern	Grid Ref: NJ 8892 0753



Sub Cpt	Area (ha)	Net Plantable Area (ha)	No of trees	Species Mix		Fence (m)	Tree Shelters
				% Broadleaves	% Conifers		
a	7.06	6.56	16,500	50	50	1,150	-
Open ground	0.61						
Totals	7.67	6.56	16,500	50	50	1,150	-
Notes	Approx 990m of internal paths @ say 5m width =0.50ha						

Species Schedule

Sub Cpt	Broadleaves													Conifers			
	Oa	Syc	Ash	W/E	Ch	Row	Ho	B/T	Bi	HZ	W/B	Sal	Al	SP	L	NS	DF
a	3,300		2,900	400	400	400	170	340			340			1,600	3,300	2,100	1,250
Totals	3,300	-	2,900	400	400	400	170	340	-	-	340			1,600	3,300	2,100	1,250

 <p>ABERDEEN CITY COUNCIL</p>	<p>THE GRANITE CITY WOODLANDS Phase 1 Woodland Creation Programme</p>	<p>Ref No: Cpt 10</p>
		<p>FID No:</p>
<p>Area: 1.73ha</p>	<p>Howes Road</p>	<p>Grid Ref: NJ 8914 0899</p>

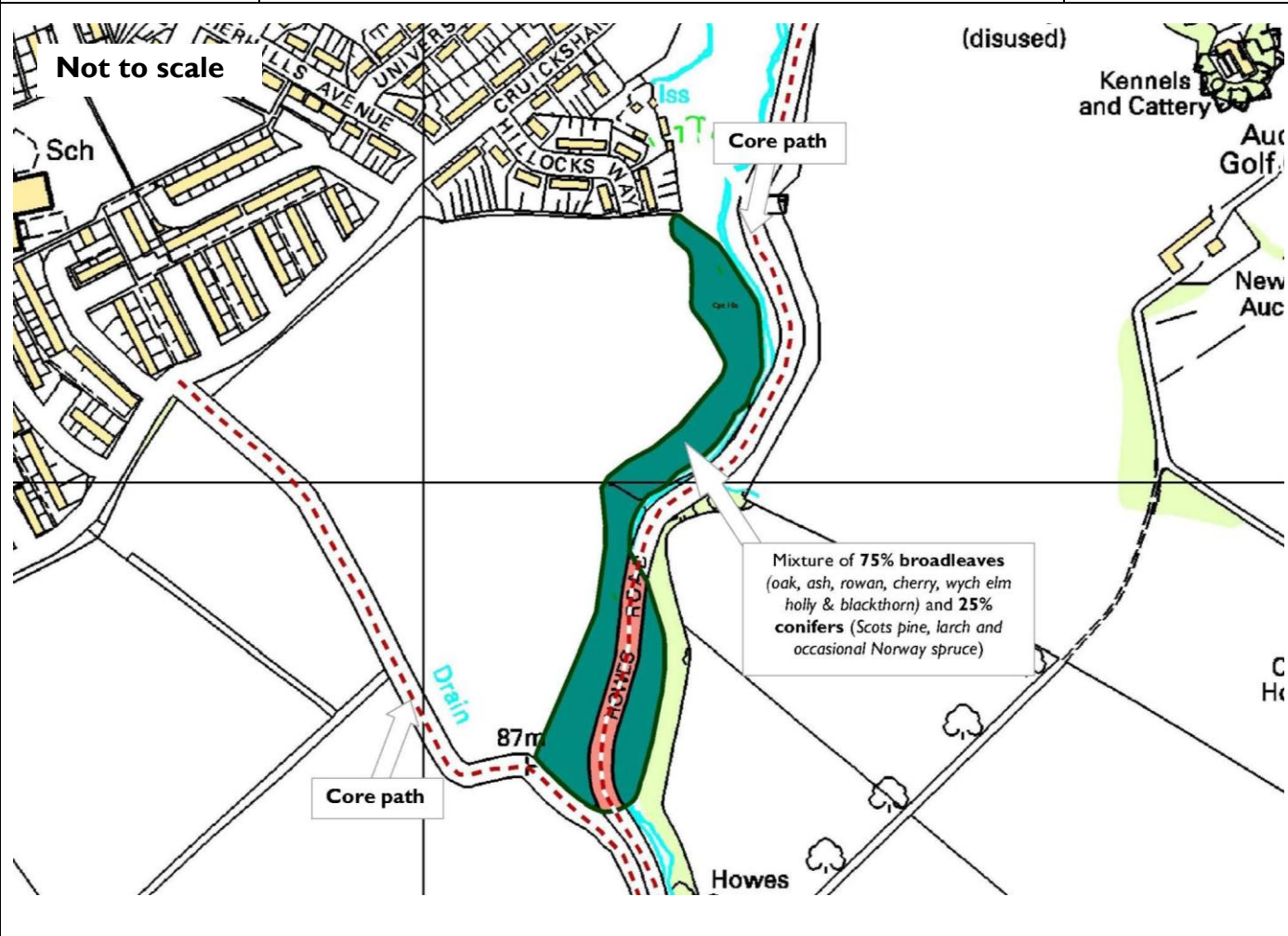

Reproduced from Ordnance Survey mapping with the permission of the Controller of Her Majesty's Stationery Office. © Crown Copyright. Unauthorised reproduction infringes Crown Copyright and may lead to prosecution or civil proceedings. Aberdeen City Council - Licence No. 100023401 (2009)*

Sub Cpt	Area (ha)	Net Plantable Area (ha)	No of trees	Species Mix		Fence (m)	Tree Shelters
				% Broadleaves	% Conifers		
a	1.17	1.17	1,900	75	25	-	1,900
b	0.28	0.28	450	75	25	-	450
Other	0.28	-	-	-	-	-	-
Totals	1.73	1.45	2,350	75	25		2,350
Notes	Sub Cpts a & b separated by public road						

Species Schedule

Sub Cpt	Broadleaves													Conifers			
	Oa	Syc	Ash	W/E	Ch	Row	Ho	B/T	Bi	Hs	W/B	Sal	Al	SP	L	NS	DF
a	600		500	100	100		50	50						150	100	150	100
b	100		100	50	50	25	25	25						25	25	25	
Totals	700	-	600	150	150	25	75	75	-	-	-	-	-	175	125	175	100

Scheme Name	Grid Reference* <i>*approx centre point of scheme</i>	Gross Area (ha)	Net area to be planted (ha)	Species Mix (%)	
				B' leaves	Conifers
Seaton Community Woodland	NJ 9477 0913	8.54	8.16	55	45
Lochinch	NJ 9349 0089	3.29	2.97	55	45
Abbotswell	NJ 9406 0400	6.95	5.36	50	50
Inverdee Pitches	NJ 9324 0487	1.87	1.68	70	30
Westfield Park	NJ 9356 1030	7.55	6.09	60	40
St Fittick's	NJ 9619 0487	7.23	5.80	70	30
Danestone	NJ 9171 0975	2.20	1.88	50	50
Balgownie Drive	NJ 9289 0971	2.69	2.24	60	40
Greenfern	NJ 8892 0753	7.55	6.38	50	50
Howes Road	NJ 8914 0899	1.73	1.45	75	25
Totals		49.60	42.01		